

# RJS-TS003 LED Touch Sensor Switch



## Feature -

- water proof IP67 sealed panel mount
- full color LED illuminated available

## Application -

- home appliances
- kitchen appliances
- communication equipments
- vending machines and switches used in polluted environment

## ► SPECIFICATIONS

SWITCH SPECIFICATIONS						
POLE - POSITION		One-Channel				
CIRCUIT FEATURE		Capacitive digital signal				
OPERATING TEMPERATURE RANGE		-20°C ~ 70°C				
SEALING		IP67				
ELECTRICAL CHARACTERISTICS						
Symbol	Parameter	Conditions	MIN.	TYP.	MAX.	Units
V <sub>DD</sub>	Operating voltage		1.8	3	5.5	V
F	System oscillator	V <sub>DD</sub> = 3V	25		600	KHz
F <sub>SEN</sub>	Sensor oscillator	V <sub>DD</sub> =3V, Output no load		800		KHz
I <sub>OP</sub>	Operating current	V <sub>CC</sub> =3V, Output no load		1.5	2.7	µA
V <sub>IL</sub>	Input ports	Input low voltage	0		0.2	V <sub>DD</sub>
V <sub>IH</sub>	Input ports	Input high voltage	0.8		1.0	V <sub>DD</sub>
I <sub>OL</sub>	Output port sink current	V <sub>DD</sub> =3V, V <sub>OL</sub> =0.6V		8		mA
I <sub>OH</sub>	Output port source current	V <sub>DD</sub> =3V, V <sub>OH</sub> =2.4V		-4		mA
T <sub>R</sub>	Output response time	V <sub>DD</sub> =3V			150	mS

LED SPECIFICATIONS						
 <b>ATTENTION</b> (+)○—○(-) LEDs are Electrostatic Sensitive devices		Unit	Value / LED Color			
			Ultra Red	Ultra Blue	Ultra Yellow	
FORWARD CURRENT	I <sub>f</sub>	mA	20	20	20	
REVERSE VOLTAGE	V <sub>r</sub>	V	5.0	5.0	5.0	
REVERSE CURRENT	I <sub>r</sub>	µA	10	50	10	
FORWARD VOLTAGE@20mA	V <sub>f</sub>	V	1.95-2.5	3.3-4.0	2.1-2.5	
LUMINOUS INTENSITY@20mA	I <sub>v</sub>	mcd	220	60	50	

LED SPECIFICATIONS						
 <b>ATTENTION</b> (+)○—○(-) LEDs are Electrostatic Sensitive devices		Unit	Value / LED Color			
			Ultra White	Pure Green	Full Color	
					Red	Green
					Blue	
FORWARD CURRENT	I <sub>f</sub>	mA	20	20	20	20
REVERSE VOLTAGE	V <sub>r</sub>	V	5.0	5.0	5.0	5.0
REVERSE CURRENT	I <sub>r</sub>	µA	50	50	10	50
FORWARD VOLTAGE@20mA	V <sub>f</sub>	V	3.3-4.0	3.3-4.1	1.95-2.5	3.3-4.1
LUMINOUS INTENSITY@20mA	I <sub>v</sub>	mcd	120-200	450	200	280

■ Physical and electrical information of LED will be provided upon customer's request on switches .

## ► HOW TO ORDER

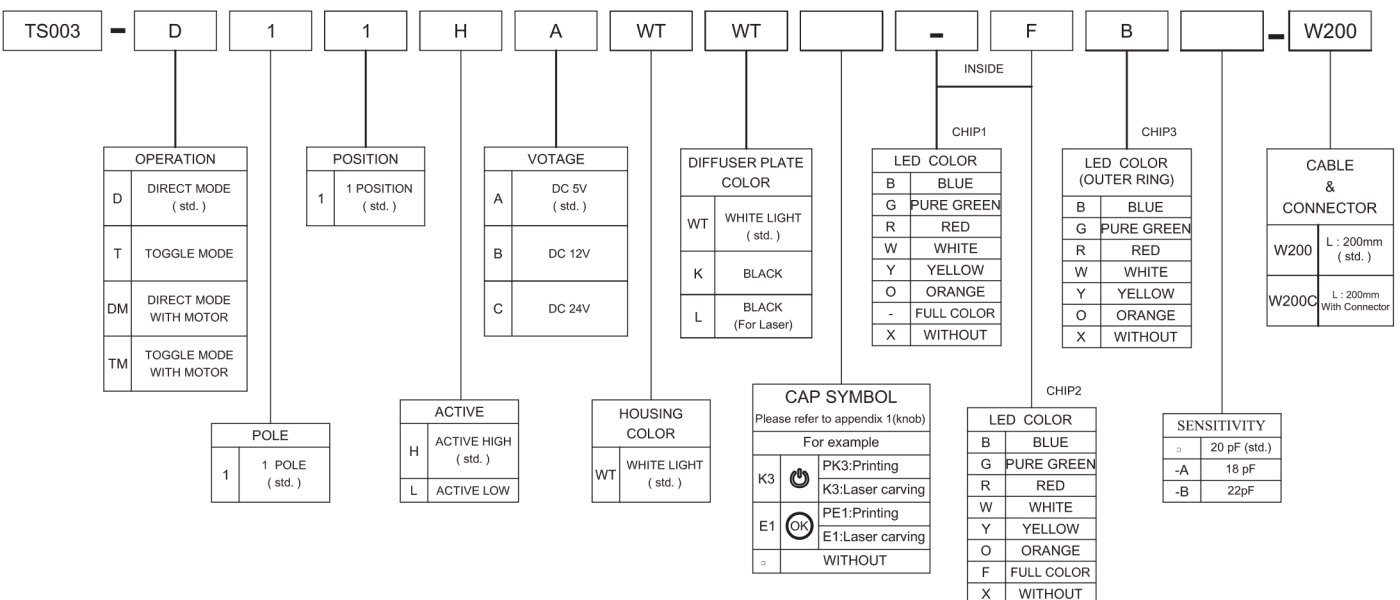

# RJS-TS003 LED Touch Sensor Switch

## ▶ DIMENSION & FRAME TYPE

TS003 - D11HAWTWT□□□□-W200

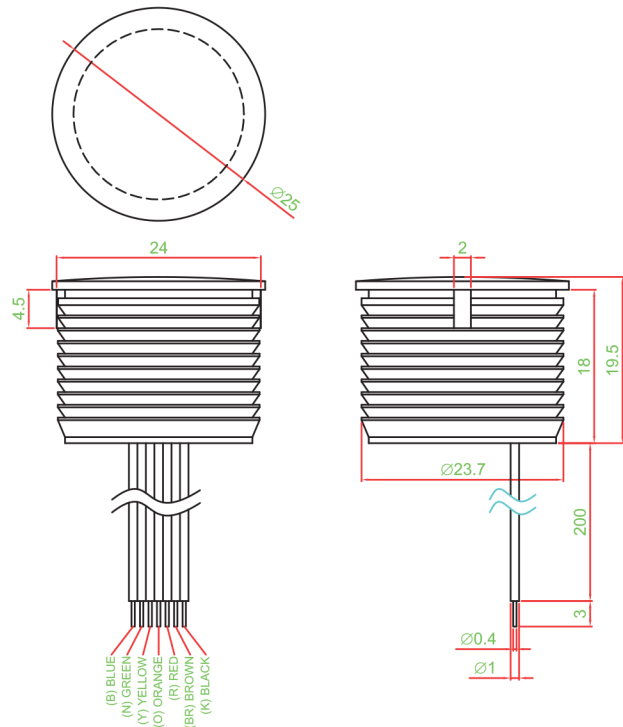

## ▶ PANEL CUT OUT

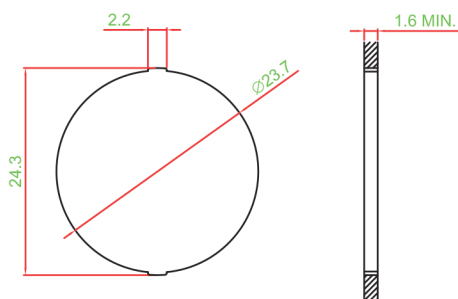

## ▶ SCHEMATIC

### SINGLE COLOR

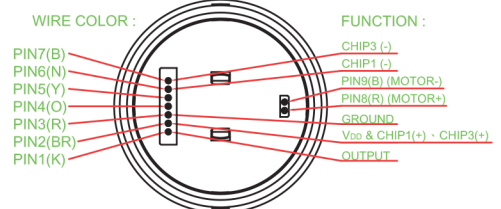

### TWO COLOR

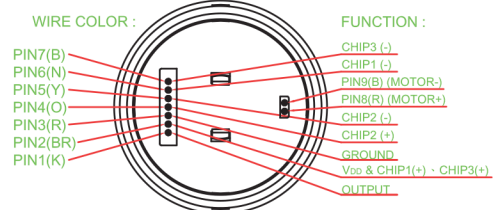

### FULL COLOR

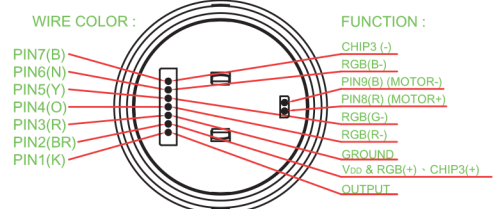

## ▶ MATERIAL

- COVER : PP
- ACTUATOR : POM
- BASE FRAME : PA + GF
- TERMINAL : PHOSPHOR BRONZE SILVER PLATING
- SPRING : PHOSPHOR BRONZE SILVER PLATING